

Vista desde la entrada principal del Hotel.

7. PLANOS

1. Northeast Aerial View / Vista Aérea desde el Noreste
2. Aerial View from the North / Vista Aérea desde el Norte
3. View from 'La Malagueta' Beach / Vista desde la playa de 'La Malagueta'
4. View from the East Dock 1 / Vista desde el Muelle 1
5. View from the East Dock 2 / Vista desde el Muelle 2
6. Night View from the East Dock / Vista Nocturna desde el Muelle de Levante
7. View from the Tower Main Entrance / Vista desde la Entrada Principal de la Torre
8. View from the Congress Center Entrance / Vista desde el Auditorio del Centro de Congresos
9. View from the Lobby / Vista desde el Lobby del Hotel
10. View from the Congress Auditorium / Vista desde el Auditorio del Centro de Congresos
11. View from the Swimming Pool / Vista desde la Piscina
12. View from the Standard Room / Vista desde la Habitación Estándar
13. View from the Bathroom / Vista desde el Baño
14. Site Lay Out Plan / Plano de Emplazamiento
15. Basement Floor-1 / Planta Sótano-1
16. Ground Floor / Planta Baja
17. First Floor Mezzanine / Planta Primera
18. Second Floor - Terrace / Planta Segunda y Terraza
19. Third Floor Facilities / Planta Tercera Instalaciones
20. Uses Schemes / Esquemas de Usos
21. Tower Room Types / Tipologías de Habitaciones
22. Tower Type Floor, Standard Rooms / Planta Tipo de Torre, Habitaciones Estándar
23. Tower Type Floor, Standard and Superior Rooms / Planta Tipo de Torre, Habitaciones Estándar y Superior
24. Tower Type Floor, Standard Suites / Planta Tipo de Torre, Suites Estándar
25. Tower Type Floor, Standard and Superior Suites / Planta Tipo de Torre, Suites Estándar y Superior
26. Tower Type Floor, Royal Suites / Planta Tipo de Torre, Suites Reales
27. Tower Restaurant-Spa Wellness Floor / Planta de Torre del Restaurante y Wellness Spa
28. Southwest Elevation / Alzado Suroeste
29. Northwest Elevation / Alzado Noroeste
30. Longitudinal Section / Sección Longitudinal
31. Cross Section / Sección Transversal





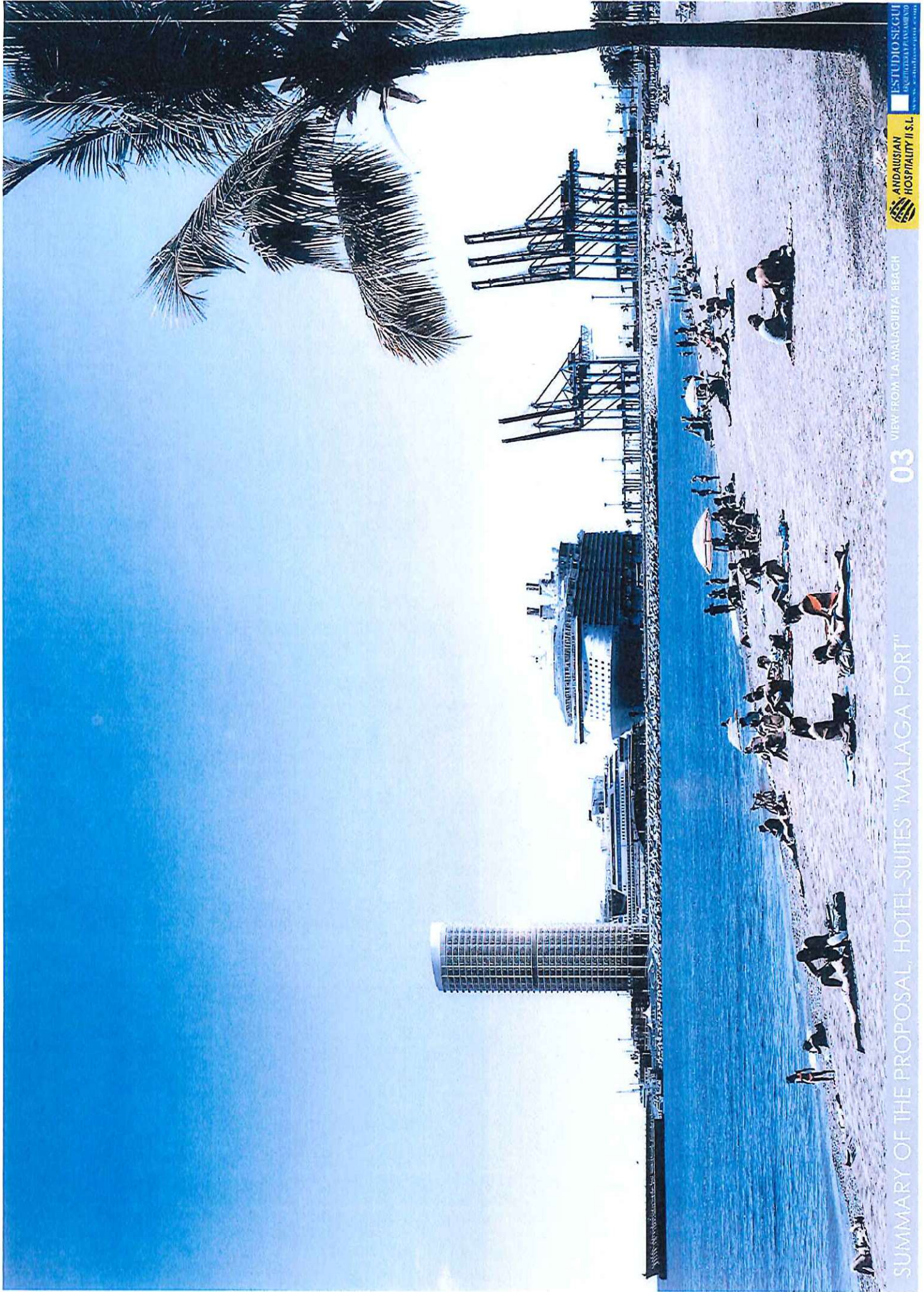





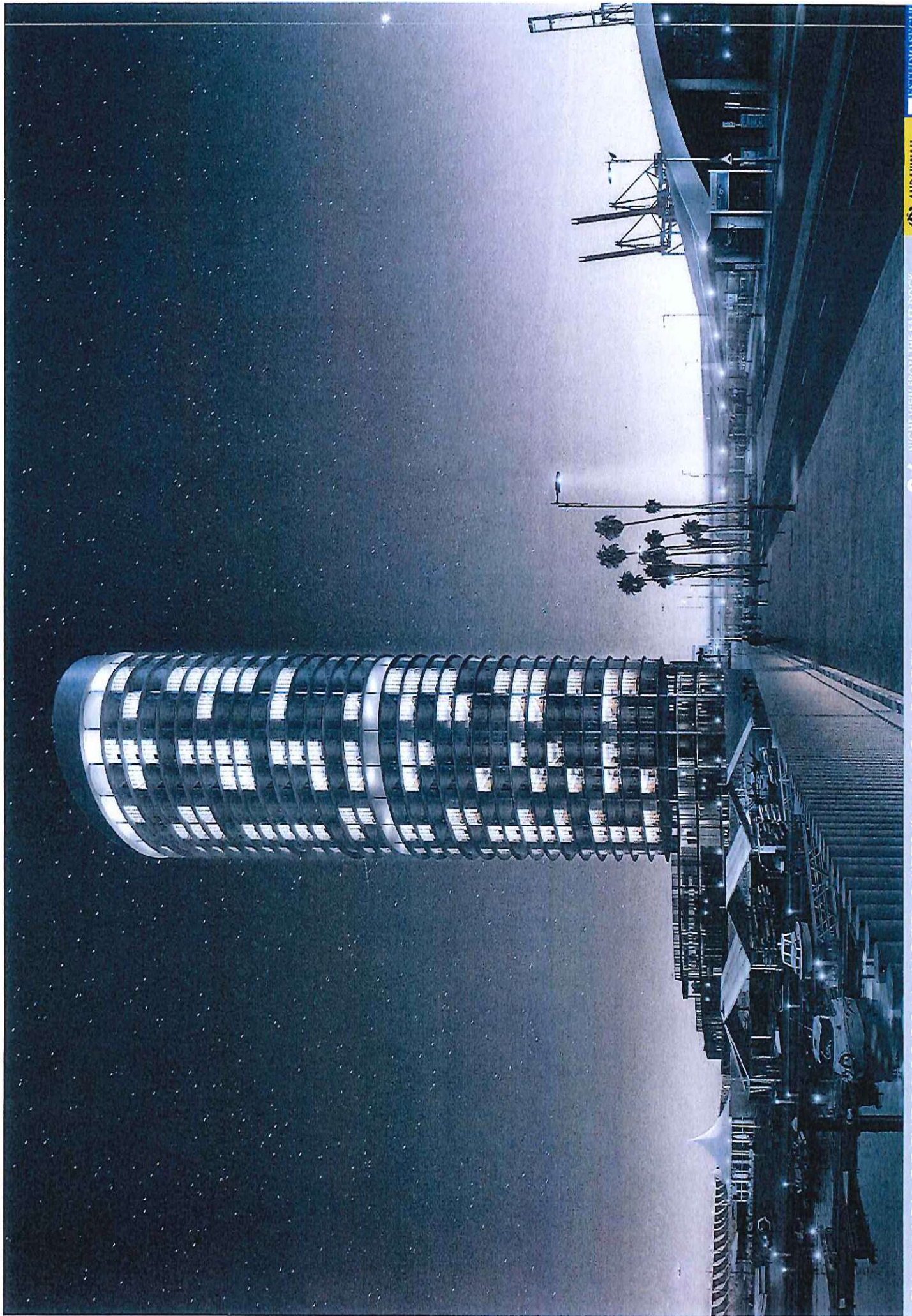



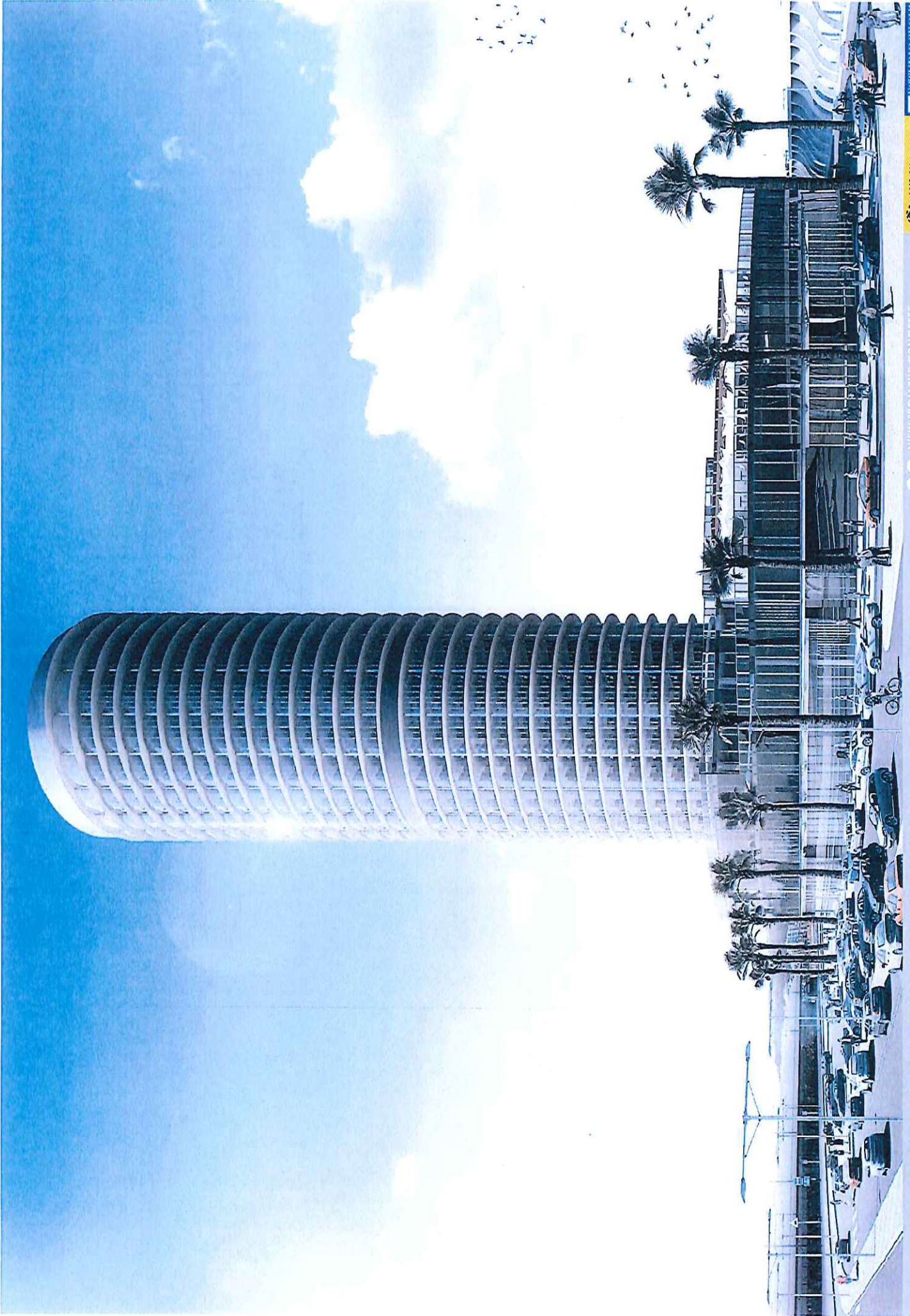



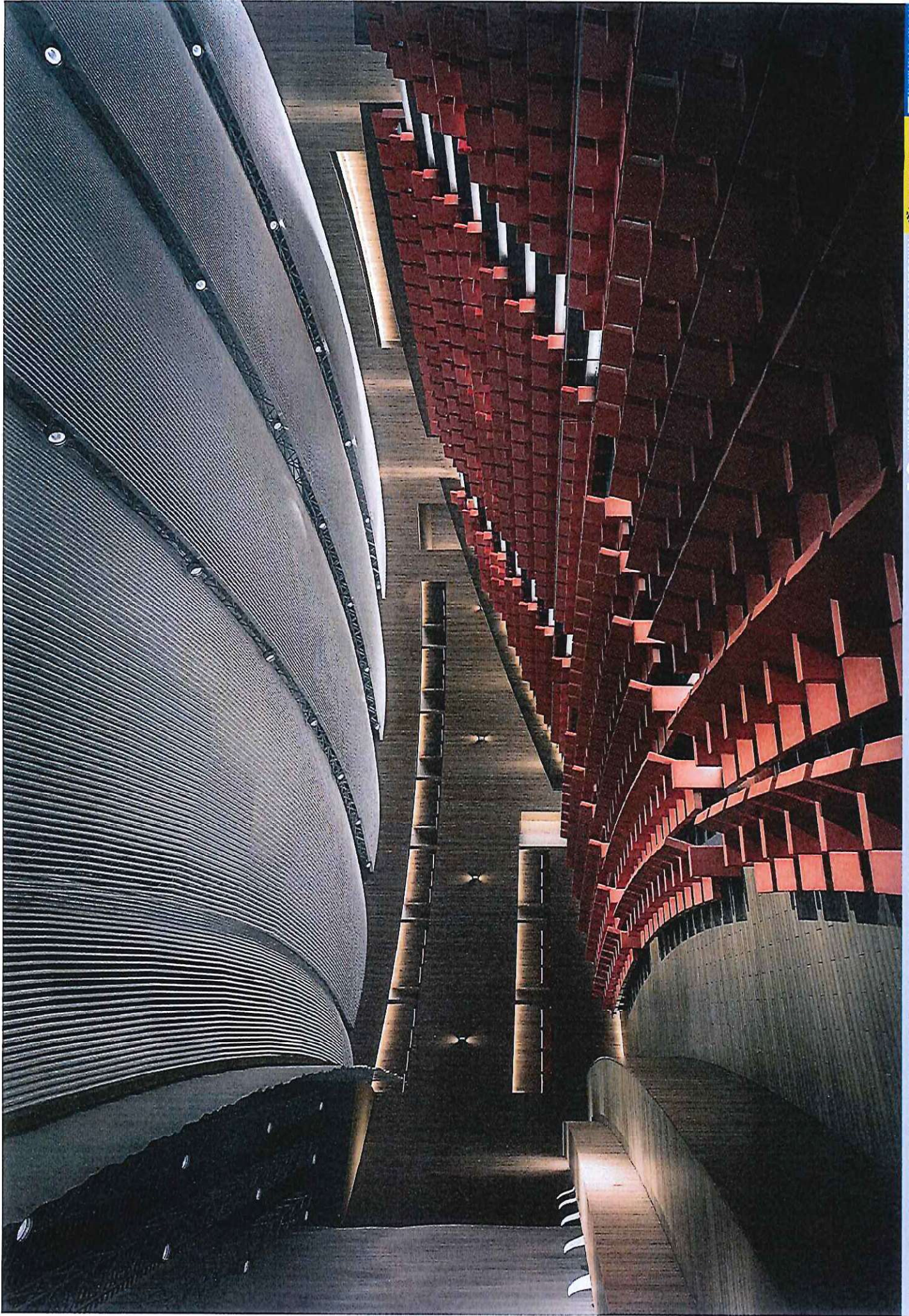







Uses

- 01 East Dock Avenue
- 02 Hotel Access
- 03 Retail Area Access
- 04 Casino Access
- 05 Congress Center Access
- 06 Parking Pedestrian Exit
- 07 Parking Entrance
- 08 Parking Exit
- 09 Parking BUS
- 10 Taxi-Microbus

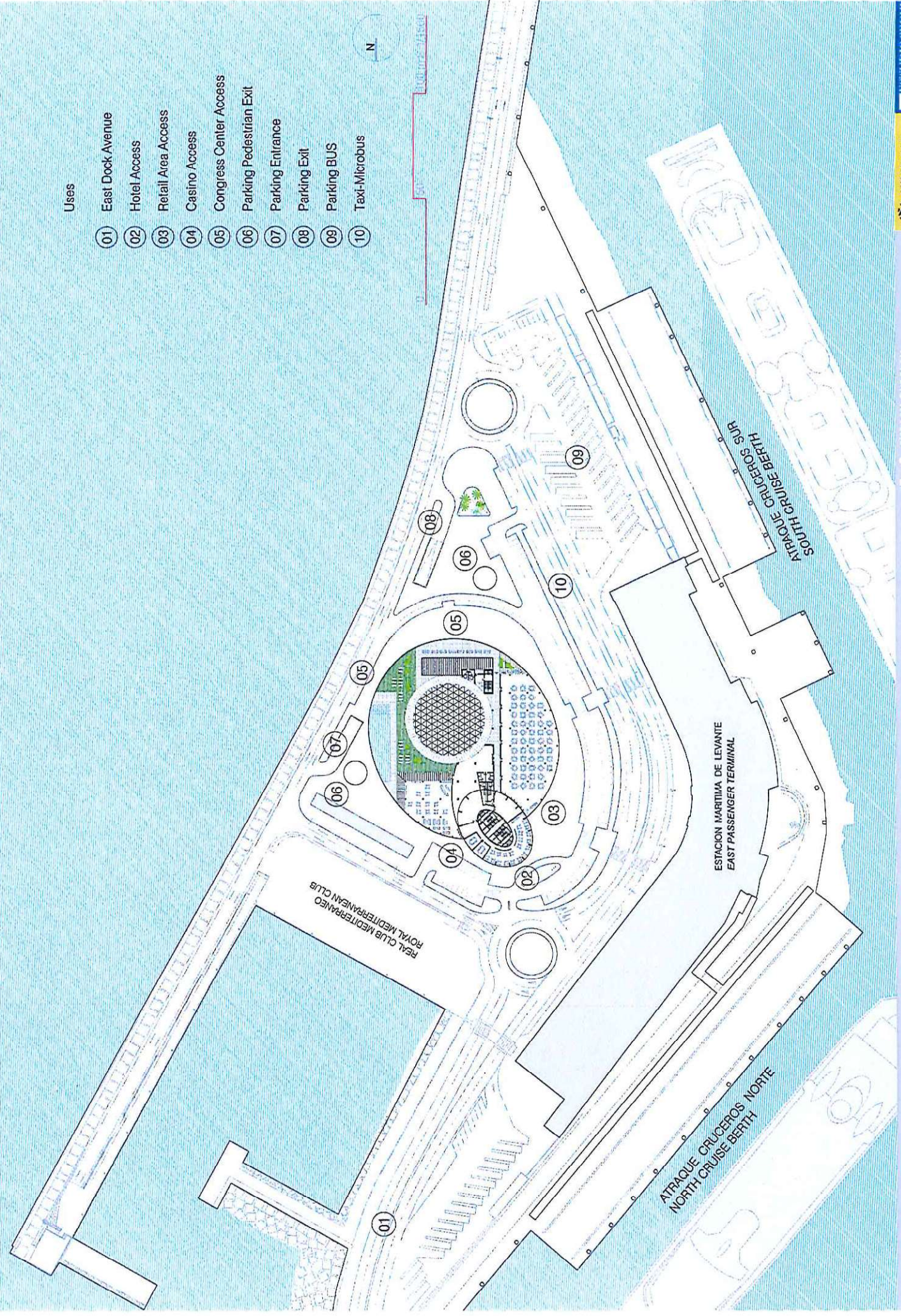

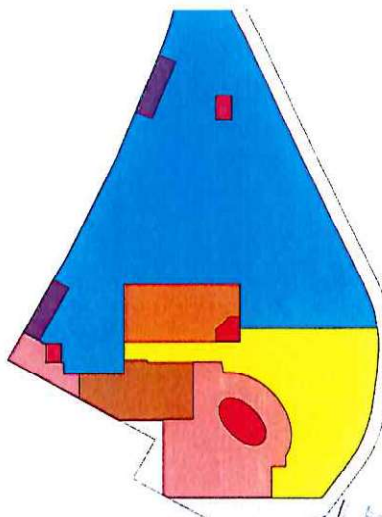

- Uses / Usos
- PARKING RAMPS / ACCESO RODADO
 - PUBLIC PARKING / APARCAMIENTO PÚBLICO
 - HOTEL PRIVATE PARKING / APARCAMIENTO PRIVADO DEL HOTEL
 - CASINO PRIVATE PARKING / APARCAMIENTO PRIVADO DEL CASINO
 - CONGRESS CENTER / CENTRO DE CONGRESOS
 - TECHNICAL FACILITIES / INSTALACIONES GENERALES
 - VERTICAL COMMUNICATION / NUCLEOS VERTICALES

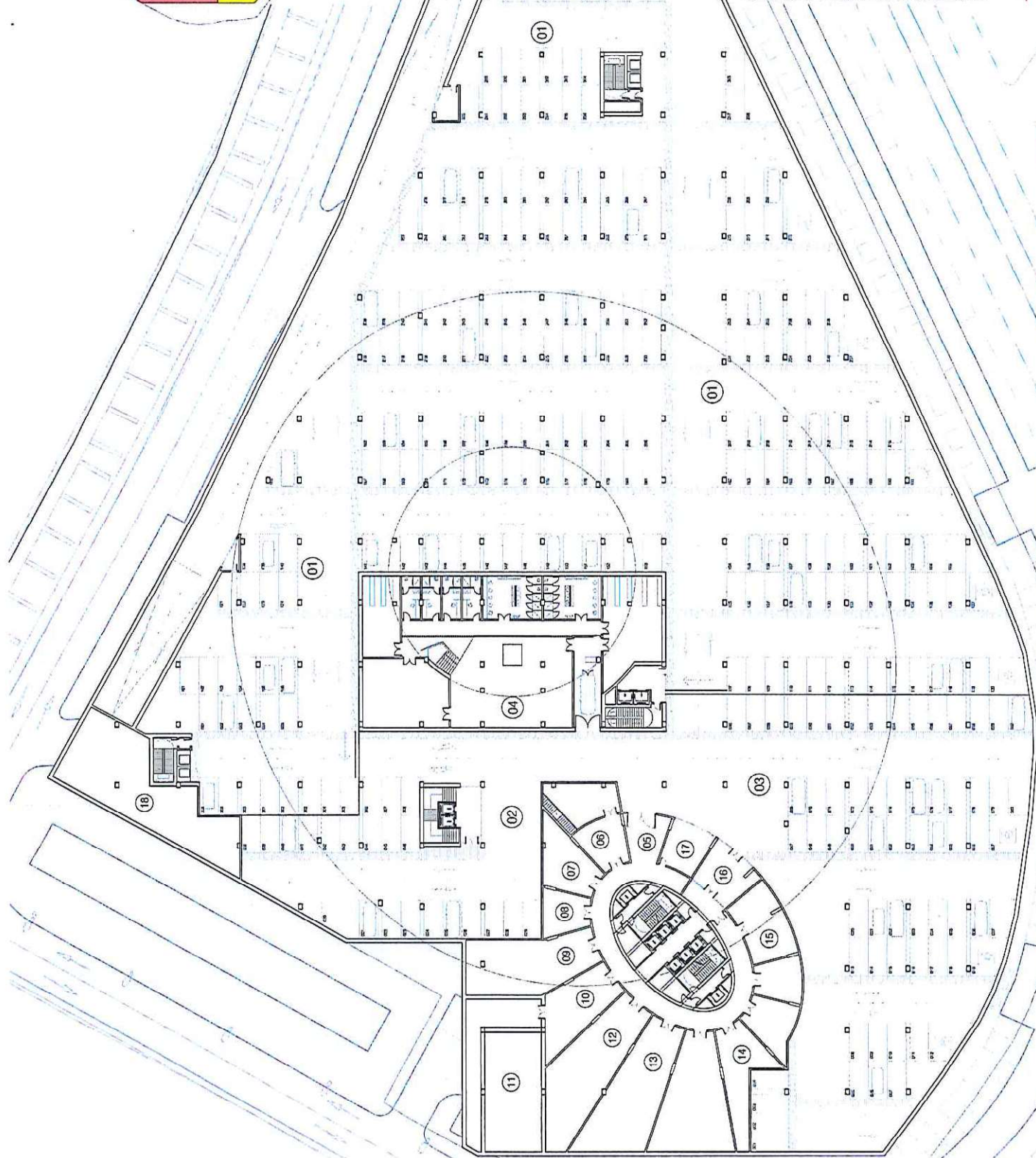

- Uses Program / Usos de usos
- 01 Public parking / Aparcamiento público
 - 02 Casino Private parking / Aparcamiento privado del casino
 - 03 Hotel Private parking / Aparcamiento privado del hotel
 - 04 Congress Center Services / Servicios Centro de Congresos
 - 05 Loading and unloading / Carga y descarga
 - 06 Coffee shop services / Servicios de cafetería
 - 07 Hotel food store / Despensa del hotel
 - 08 Refrigerators / Frigoríficos
 - 09 Hotel furniture store / Anexión de mobiliario
 - 10 Hotel store / Anexión del hotel
 - 11 Water tanks / Depósitos de agua
 - 12 Hotel laundry and linens / Lencería y lavandería del hotel
 - 13 Hotel bookstore / Vajilla del hotel
 - 14 Hotel cellar / Bodega del hotel
 - 15 Staff area / Zona de personal
 - 16 Hotel Hall / Recepción del hotel
 - 17 Control room / Oficina de control
 - 18 Facilities area / Instalaciones



5 10 15 20 25 30m SCALE 1:5000

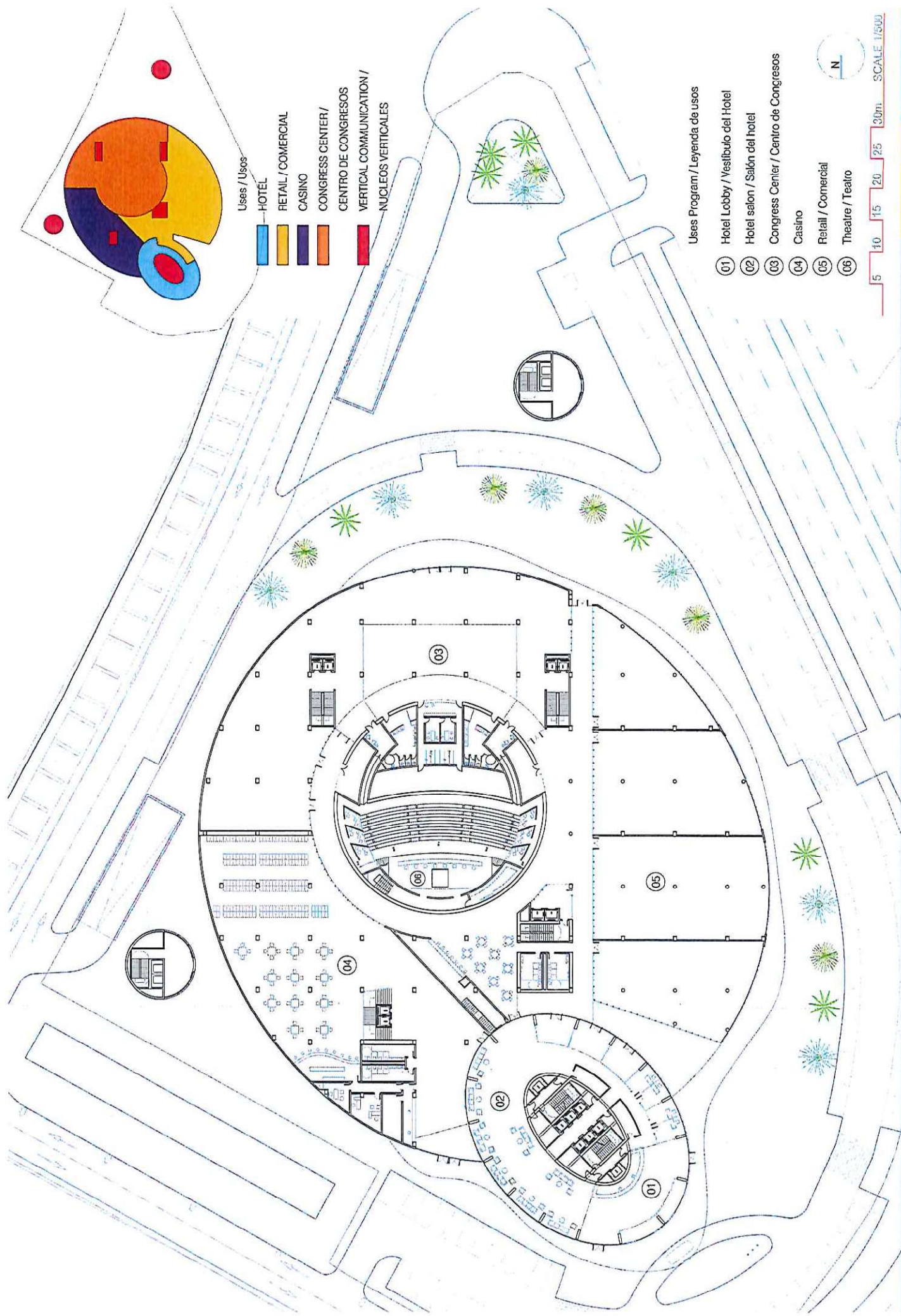

Usos / Usos

- HOTEL
- RETAIL / COMERCIAL
- CASINO
- CONGRESS CENTER /
- CENTRO DE CONGRESOS
- VERTICAL COMMUNICATION /
- NUCLEOS VERTICALES

Usos Program / Leyenda de usos

- 01 Hotel Lobby / Vestibulo del Hotel
- 02 Hotel salon / Salon del hotel
- 03 Congress Center / Centro de Congresos
- 04 Casino
- 05 Retail / Comercial
- 06 Theatre / Teatro



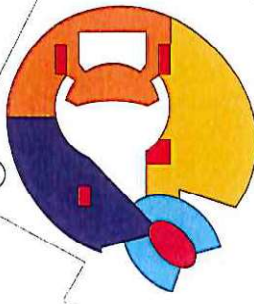
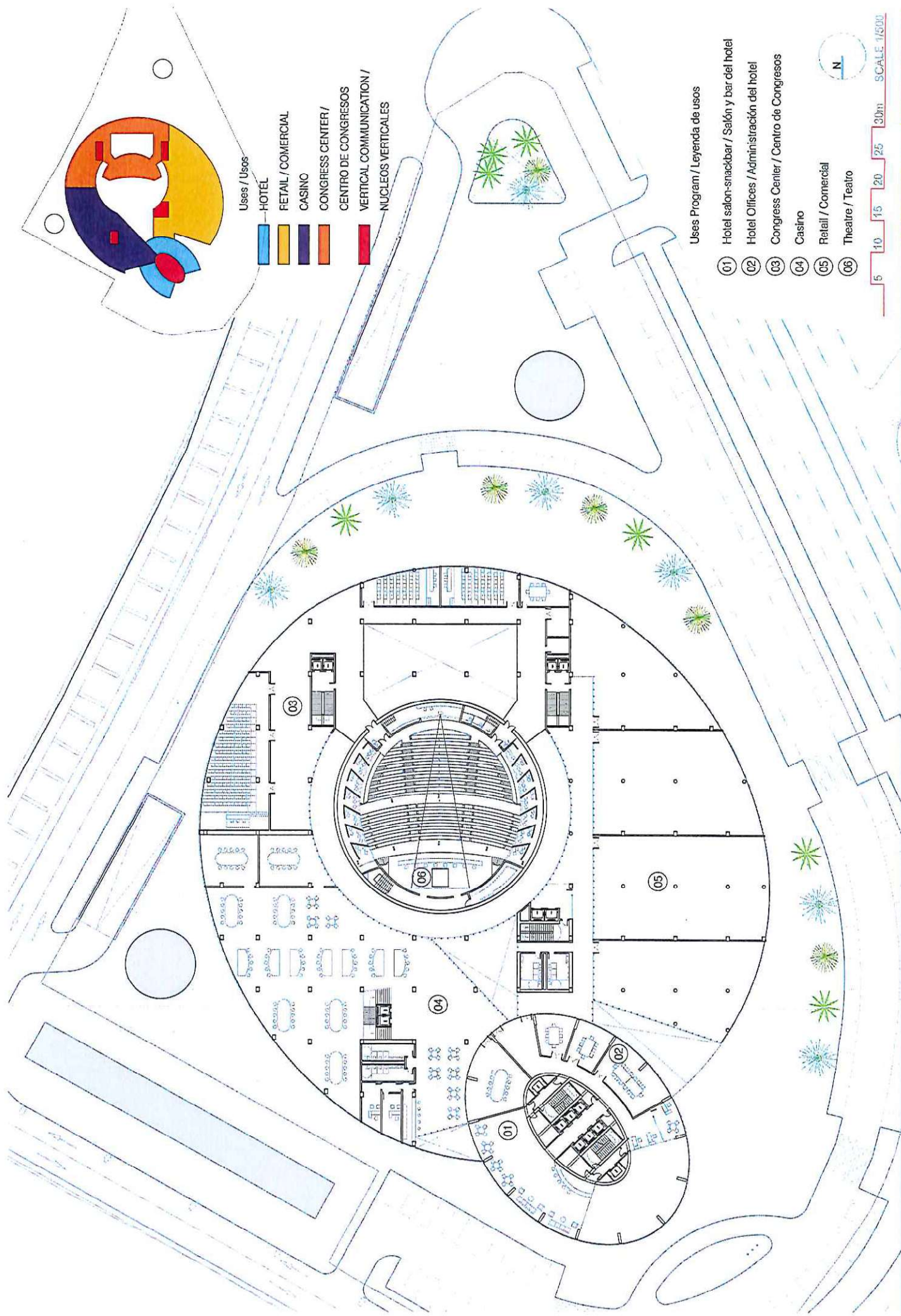

Uses / Usos

- HOTEL
- RETAIL / COMERCIAL
- CASINO
- CONGRESS CENTER /
- CENTRO DE CONGRESOS
- VERTICAL COMMUNICATION /
- NUCLEOS VERTICALES



Uses Program / Leyenda de usos

- 01 Hotel salon-snackbar / Salón y bar del hotel
- 02 Hotel Offices / Administración del hotel
- 03 Congress Center / Centro de Congresos
- 04 Casino
- 05 Retail / Comercial
- 06 Theatre / Teatro

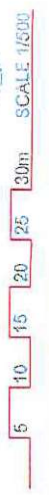

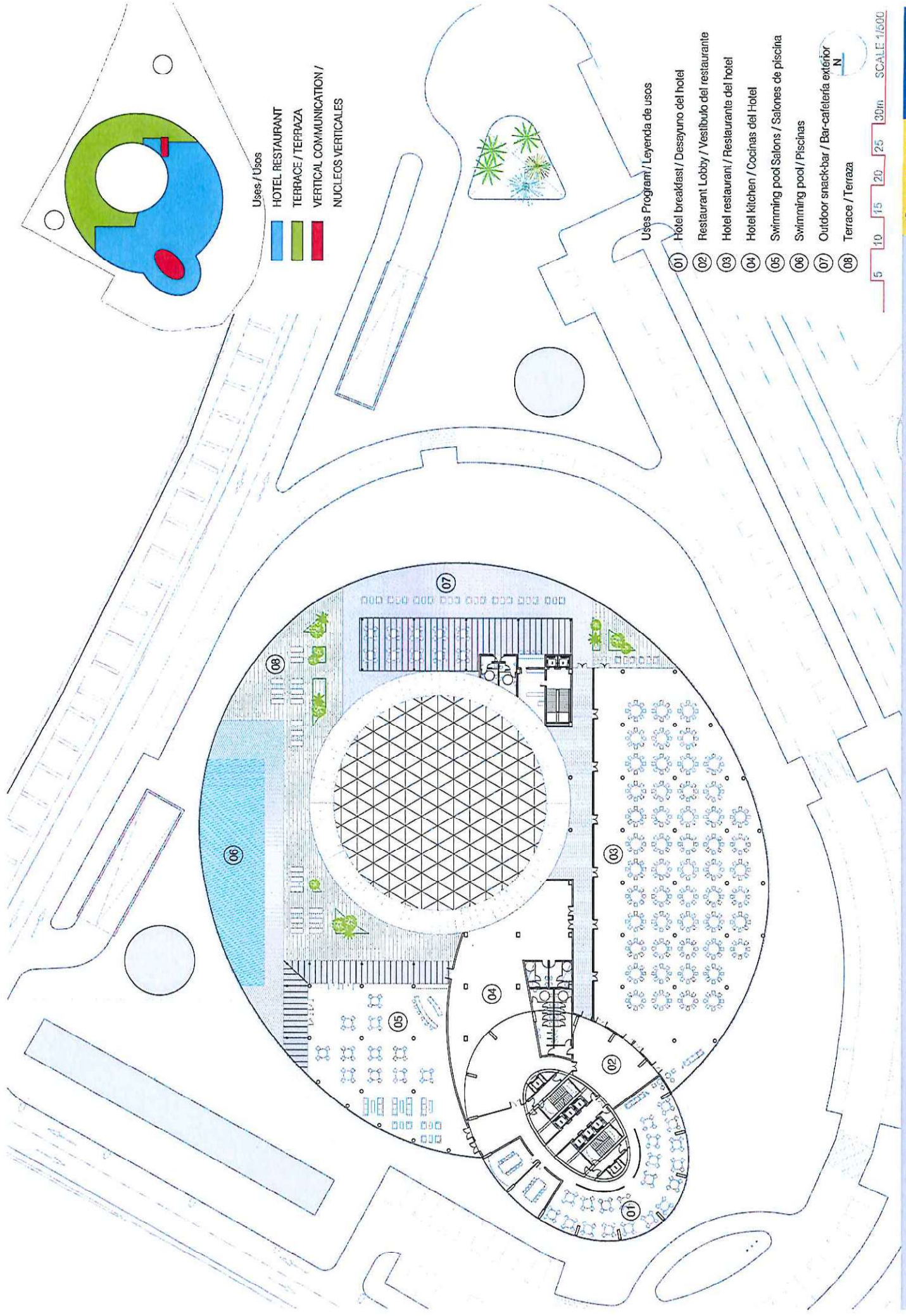

Uses / Usos

- HOTEL RESTAURANT
- TERRACE / TERRAZA
- VERTICAL COMMUNICATION / NUCLEOS VERTICALES

Uses Program / Leyenda de usos

- 01 Hotel breakfast / Desayuno del hotel
- 02 Restaurant Lobby / Vestibulo del restaurante
- 03 Hotel restaurant / Restaurante del hotel
- 04 Hotel kitchen / Cocinas del Hotel
- 05 Swimming pool Salons / Salones de piscina
- 06 Swimming pool / Piscinas
- 07 Outdoor snack-bar / Bar-cafeteria exterior
- 08 Terrace / Terraza



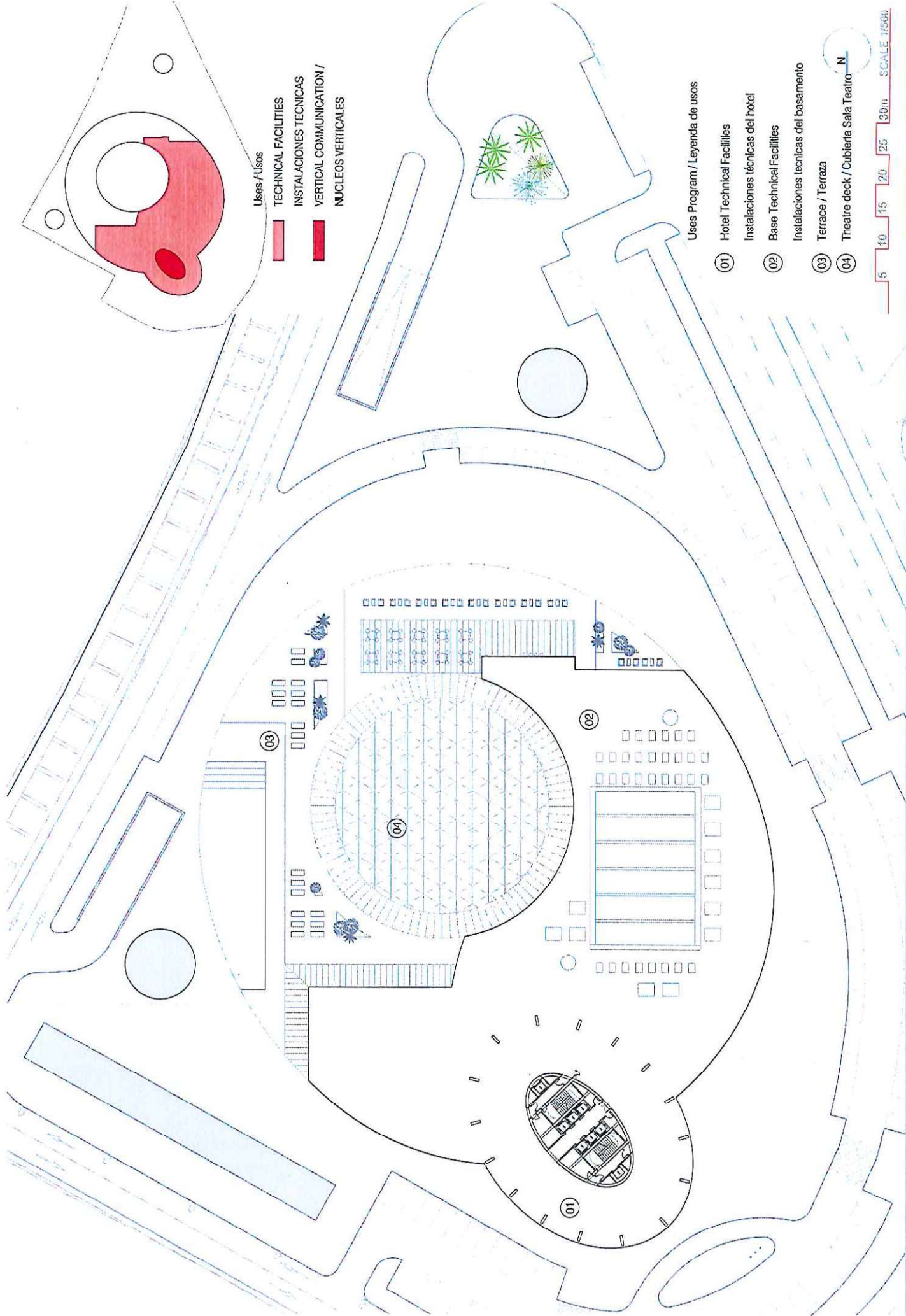

Usos / Usos
 TECHNICAL FACILITIES
 INSTALACIONES TÉCNICAS
 VERTICAL COMMUNICATION /
 NUCLEOS VERTICALES

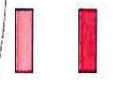

Usos Program / Leyenda de usos

- 01 Hotel Technical Facilities
- 02 Instalaciones técnicas del hotel
- 03 Base Technical Facilities
- Instalaciones técnicas del basamento
- 03 Terraces / Terraza
- 04 Theatre deck / Cubierta Sala Teatro

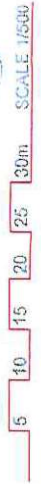

-03.40 m - BASEMENT FLOOR

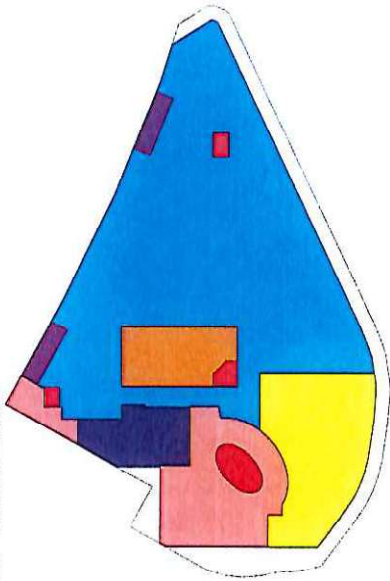

+08.50 m - SECOND FLOOR

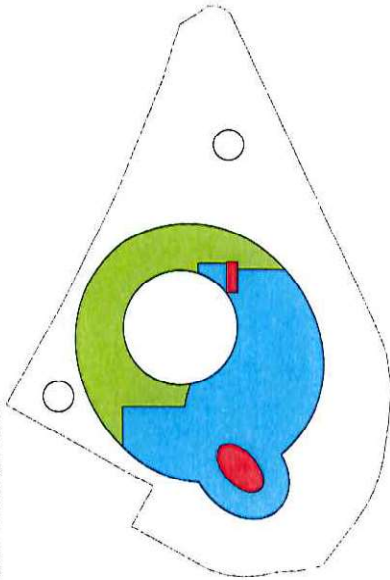

+00.00 m - GROUND FLOOR

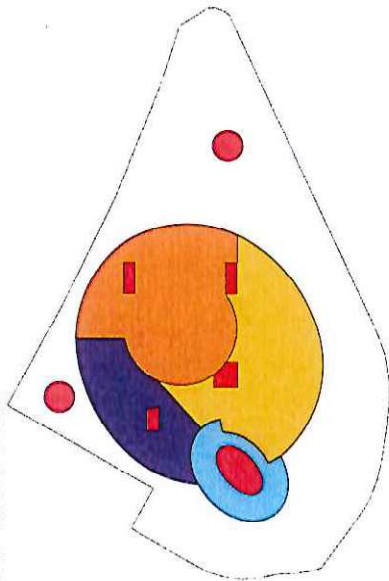

+12.24 m - THIRD FLOOR

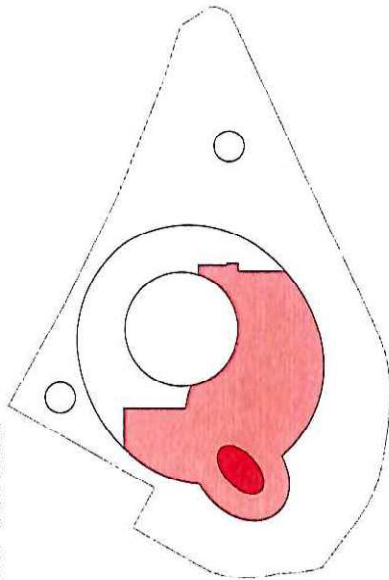

+04.78 m - FIRST FLOOR - MEZZANINE

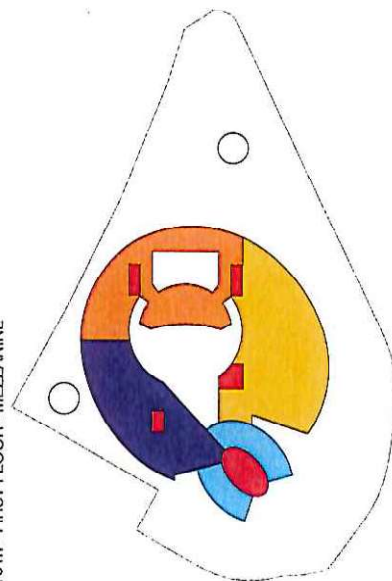

Uses / Usos

- PARKING RAMPS / ACCESO RODADO
- PUBLIC PARKING / APARCAMIENTO PÚBLICO
- HOTEL PRIVATE PARKING / APARCAMIENTO PRIVADO DEL HOTEL
- CASINO PRIVATE PARKING / APARCAMIENTO PRIVADO DEL CASINO
- HOTEL
- RETAIL / COMERCIAL
- CASINO
- TERRACE / TERRAZA
- TECHNICAL FACILITIES / INSTALACIONES TÉCNICAS
- CONGRESS CENTER / CENTRO DE CONGRESOS
- VERTICAL COMMUNICATION / NUCLEOS VERTICALES

USES SUMMARY	
ABOVE GROUND LEVEL FLOOR AREAS	
HOTEL	PROPOSAL 24,442.41 sq m
SPECIAL SUITES	8,429.58 sq m
CONGRESS CENTRE (MICE)	3,508.20 sq m
RETAIL AREA	4,055.17 sq m
OFFICES	2,588.13 sq m
TOTAL	492.24 sq m
BELOW GROUND LEVEL FLOOR AREAS	
PROPOSAL	
PARKING (PUBLIC AND PRIVATE) INCLUDING STORES AND TECHNICAL FACILITIES	485 PARKING UNITS 14,126.73 sq m
TOTAL	14,126.73 sq m

HOTEL USE SCHEME

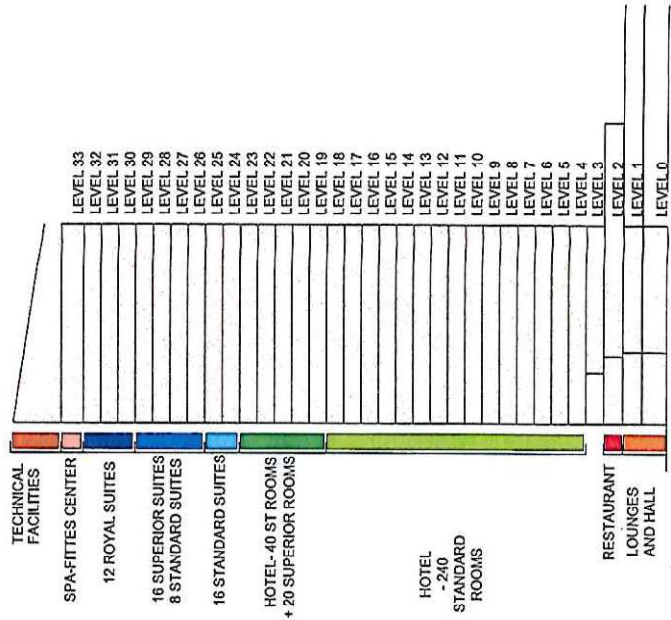

Uses Program

- 01 Bedroom
- 02 Bath
- 03 Shower
- 04 Washbasin
- 05 Wardrobe - trunk
- 06 Toilet - bidé
- 07 Kitchen
- 08 Living room

- Uses
- STANDARD ROOMS
 - SUPERIOR ROOMS / SUPERIOR SUITES
 - SUPERIOR SUITES
 - ROYAL SUITES

3. SUPERIOR SUITE (2 BEDS + SALON)

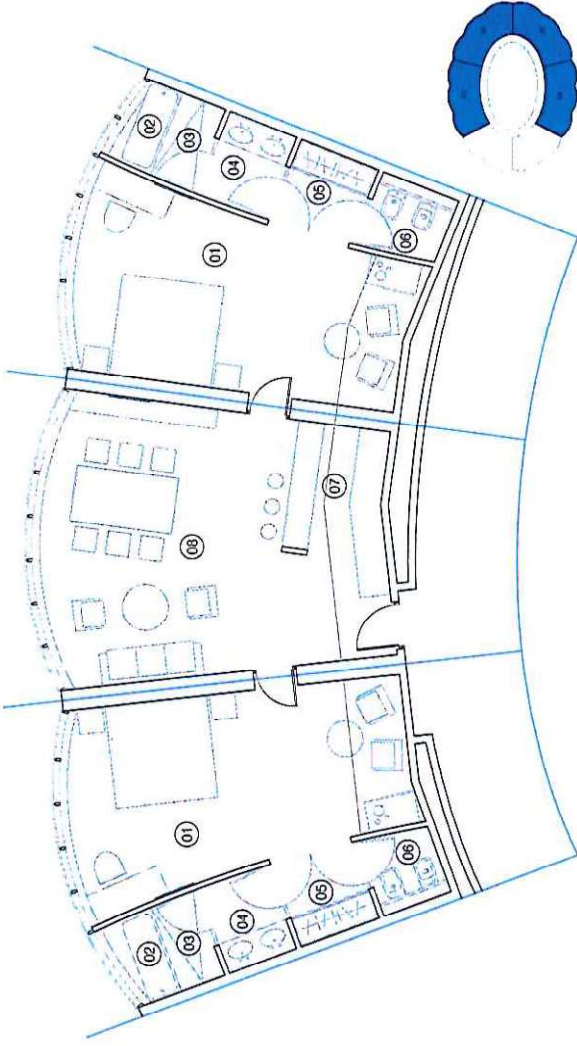

1. STANDARD ROOM (1 BED + BATHROOM)

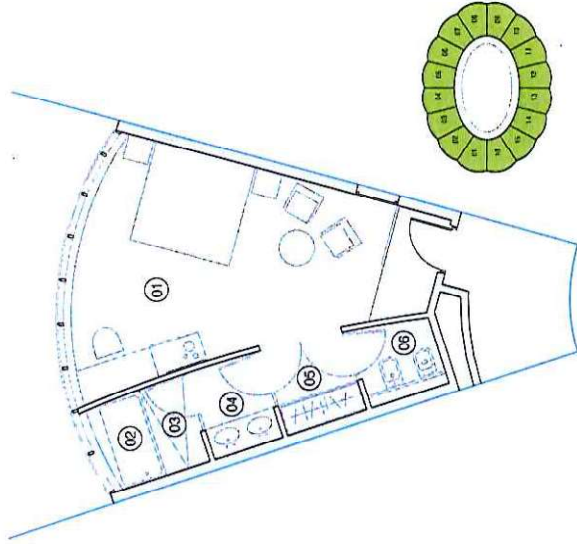

2. A. SUPERIOR ROOM (1 BED + BATH + SALON)

2. B. STANDARD SUITE (1 BED + BATH + SALON)

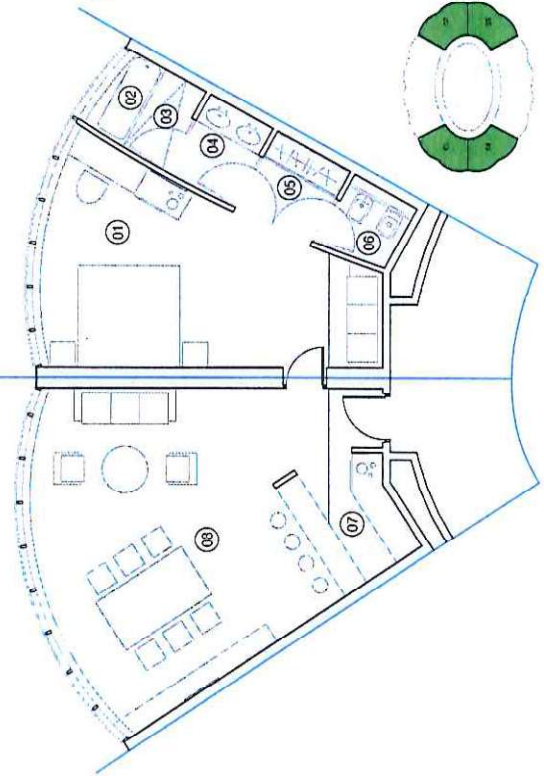

4. ROYAL SUITE (3 BEDS + SALON)

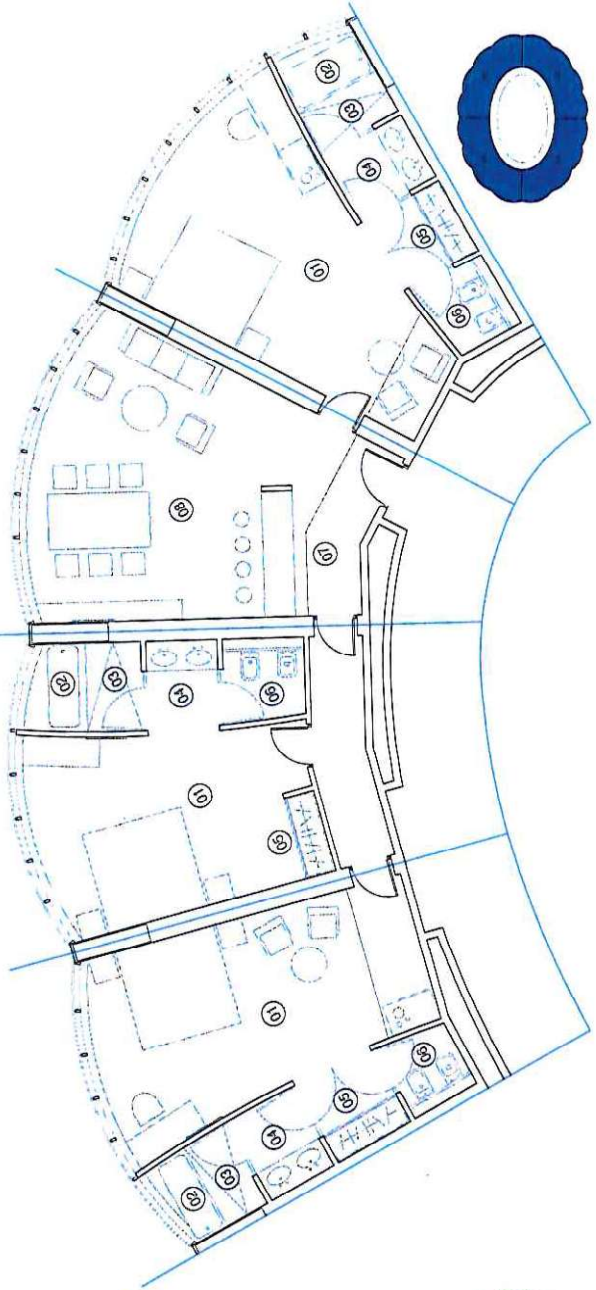

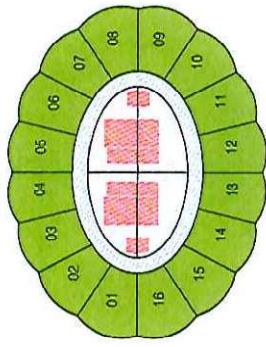

Uses

- VERTICAL COMMUNICATION
- HORIZONTAL COMMUNICATION
- STANDARD ROOMS

1 2 3 4 5 10m SCALE/1:500



HOTEL USE SCHEME

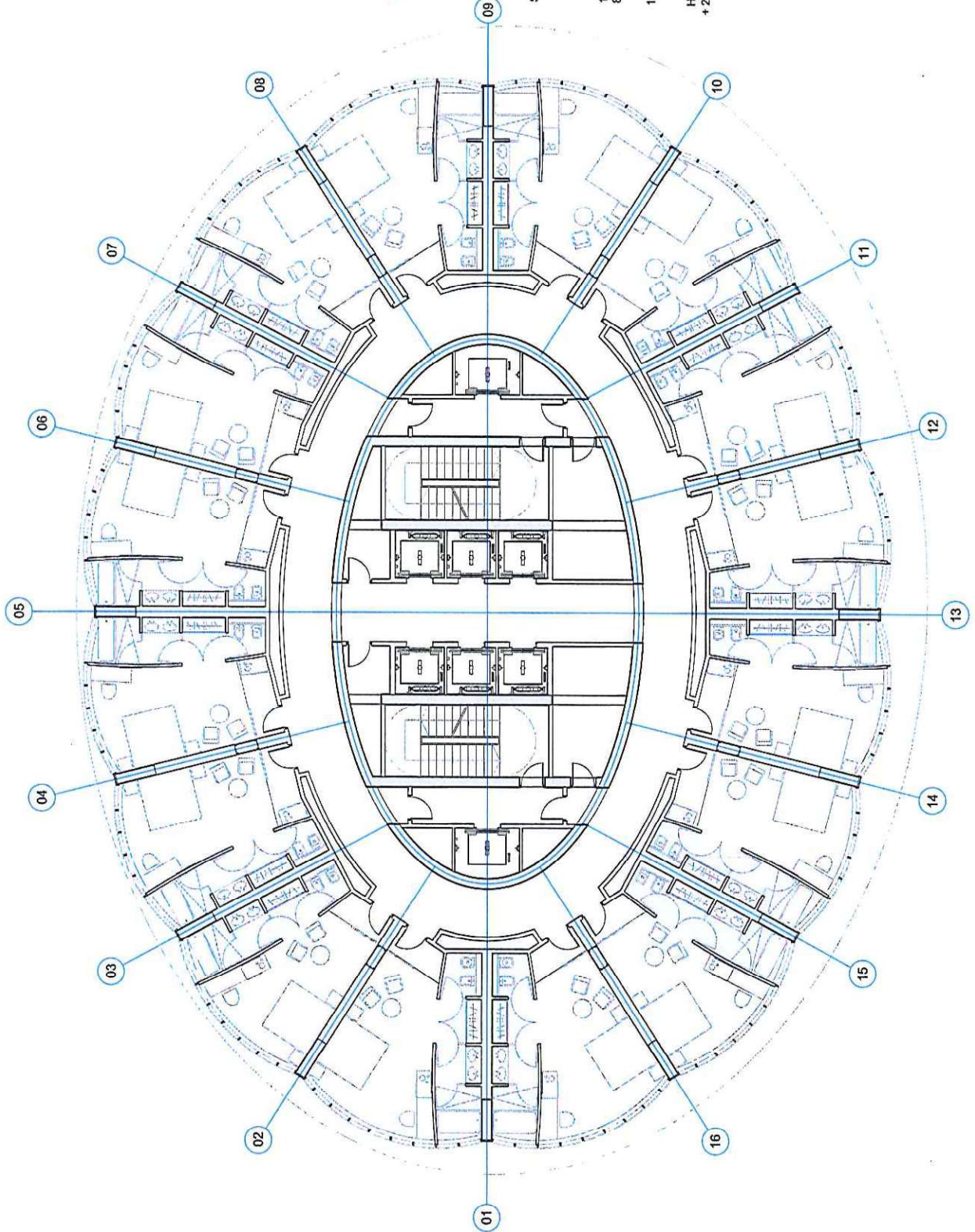
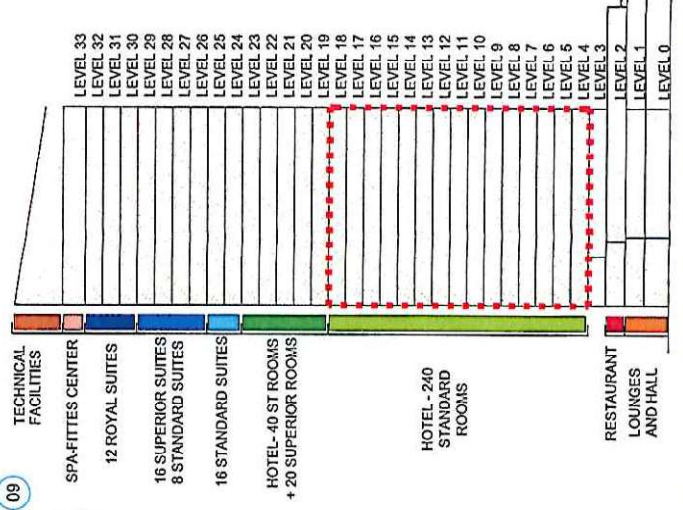

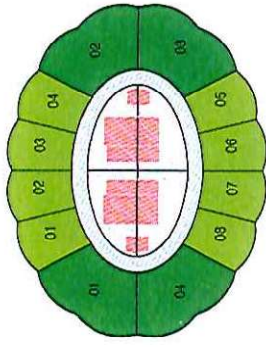

- Uses
- VERTICAL COMMUNICATION
 - HORIZONTAL COMMUNICATION
 - STANDARD ROOMS
 - SUPERIOR ROOMS

10m SCALE 1:1120

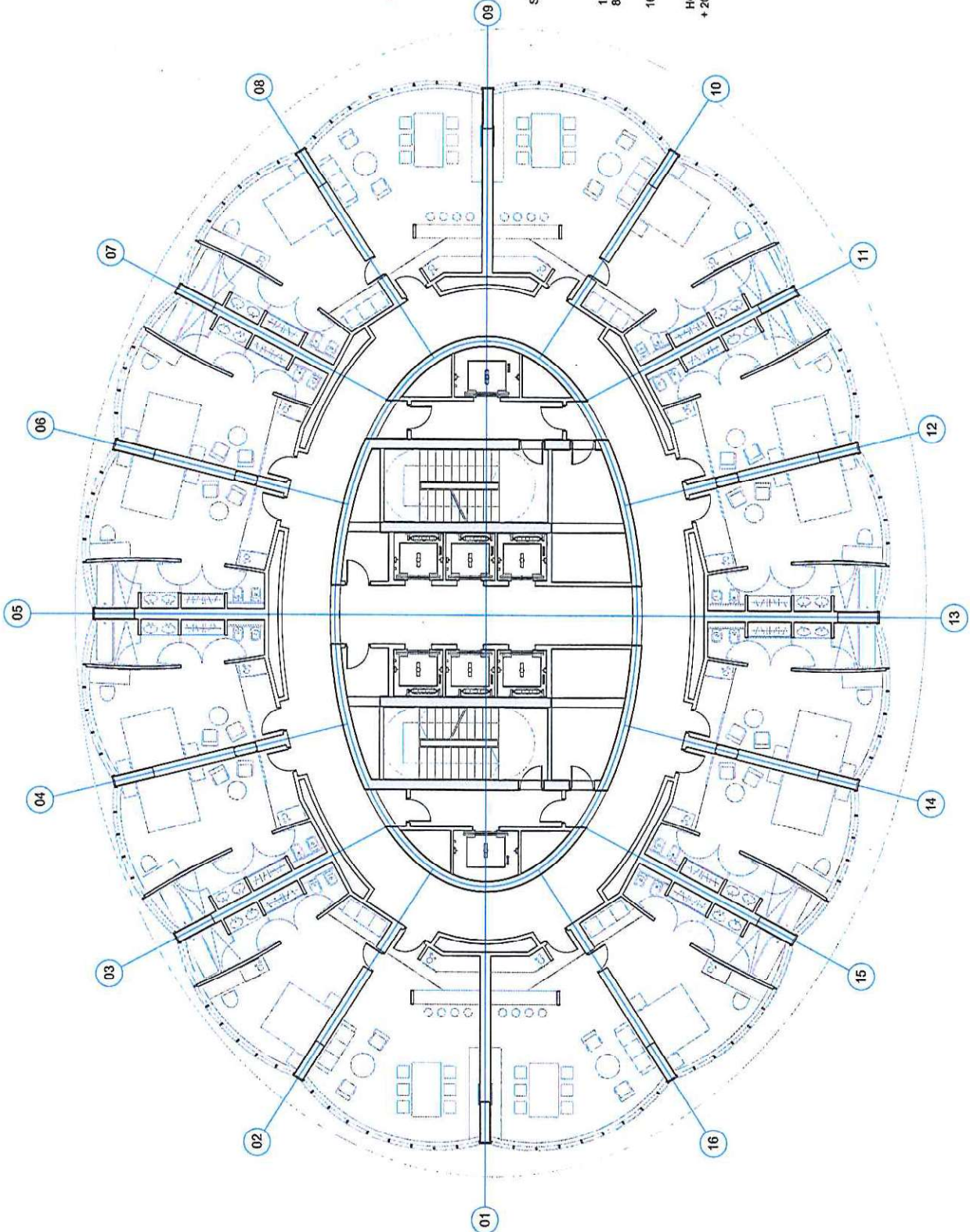

HOTEL USE SCHEME

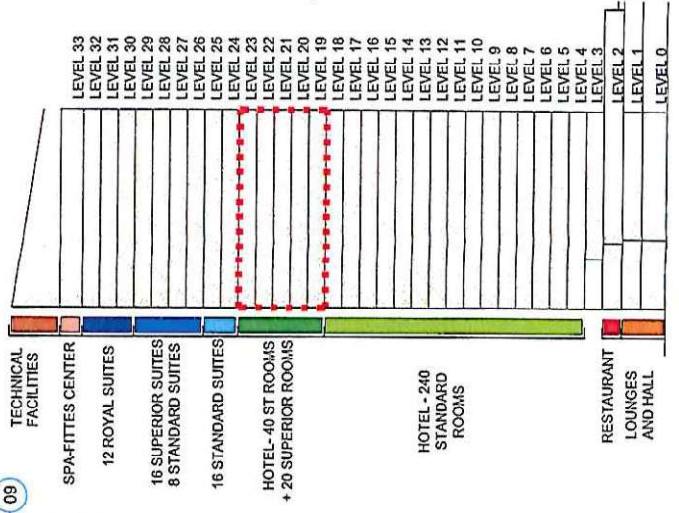

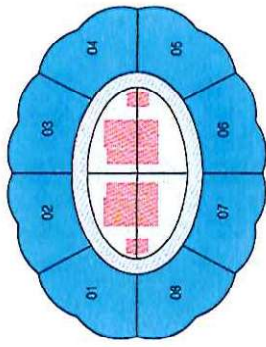

Uses

- VERTICAL COMMUNICATION
- HORIZONTAL COMMUNICATION
- STANDARD SUITES

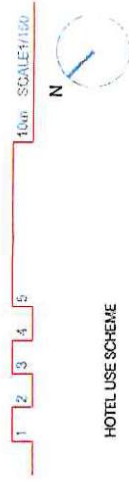

HOTEL USE SCHEME

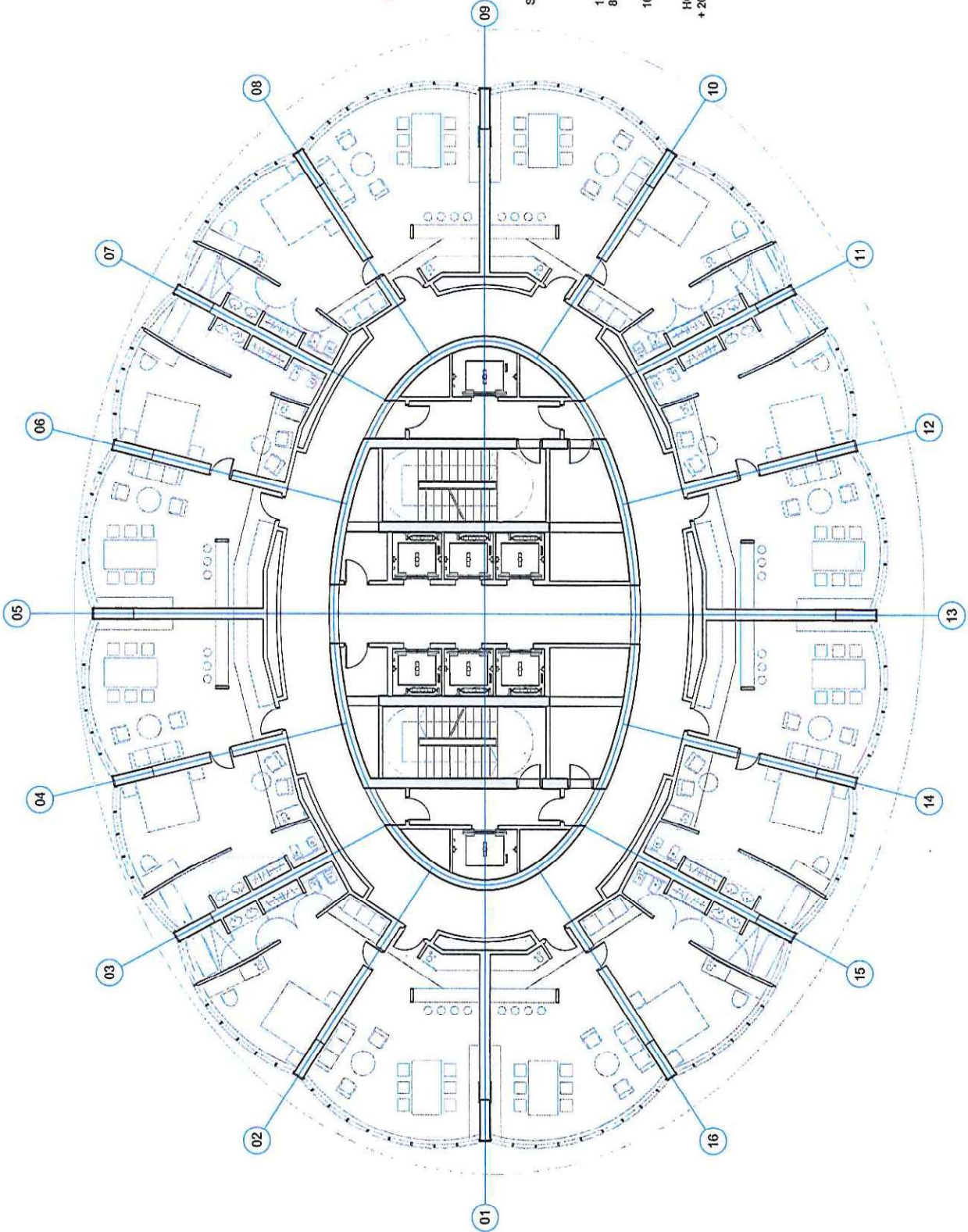
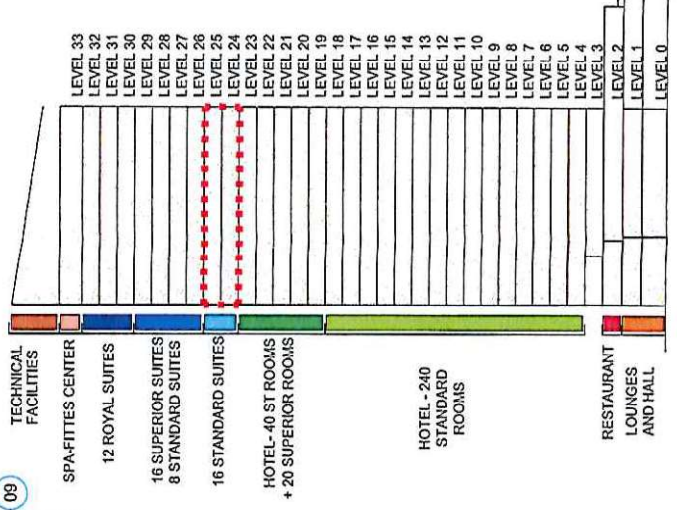

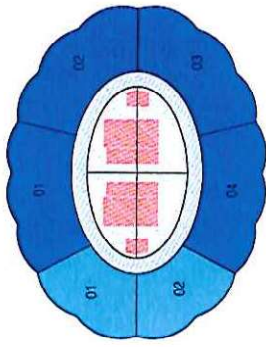

- Uses
- VERTICAL COMMUNICATION
 - HORIZONTAL COMMUNICATION
 - STANDARD SUITES
 - SUPERIOR SUITES



HOTEL USE SCHEME

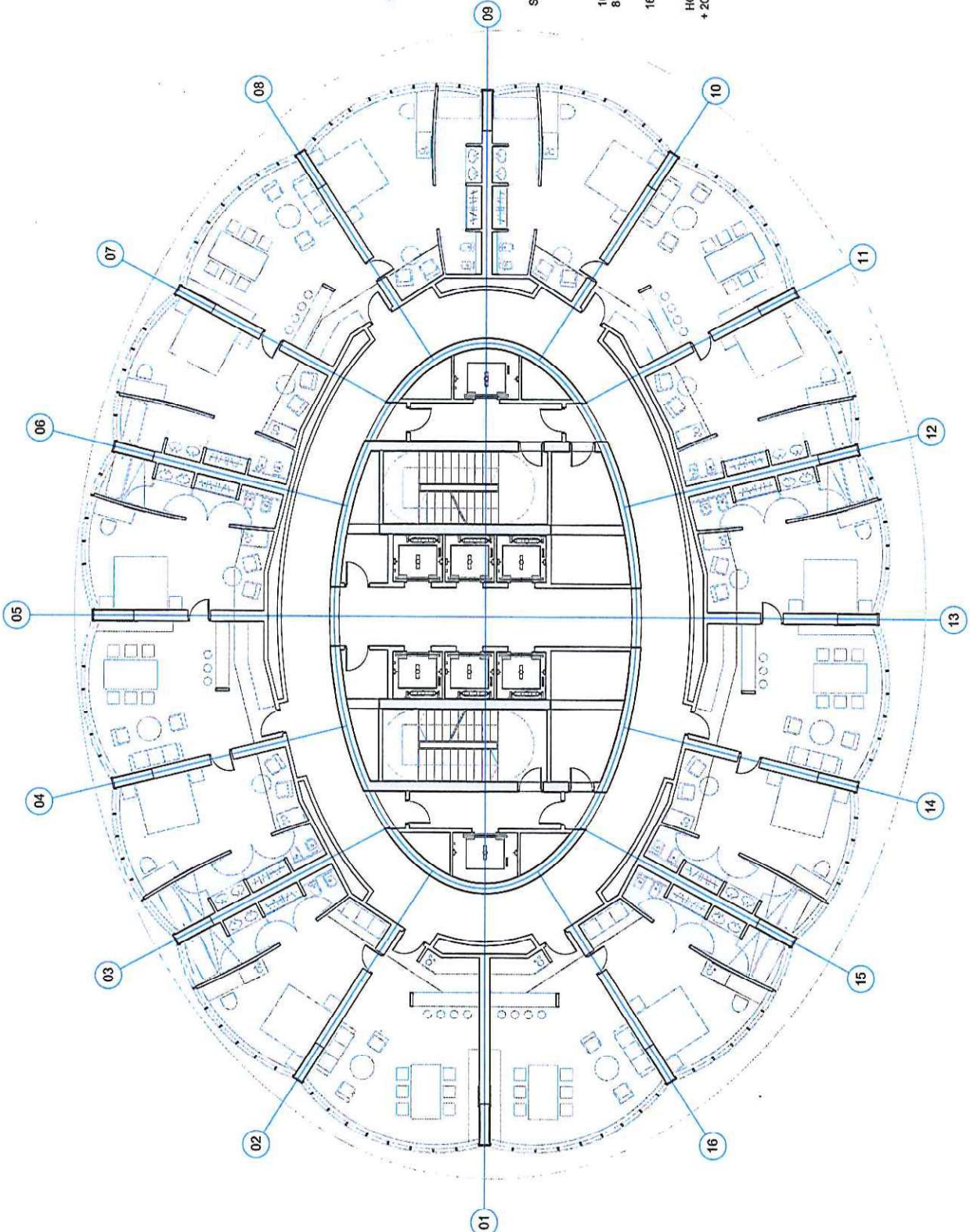
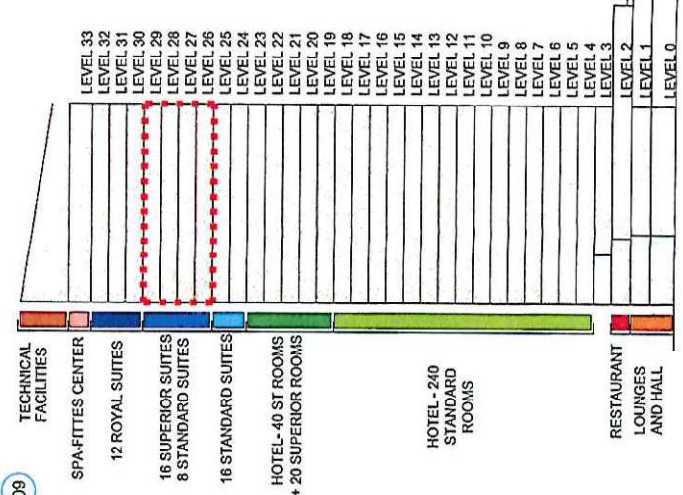

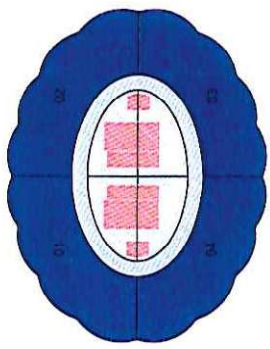

- Uses
- VERTICAL COMMUNICATION
 - HORIZONTAL COMMUNICATION
 - ROYAL SUITES

10m SCALE 1/150

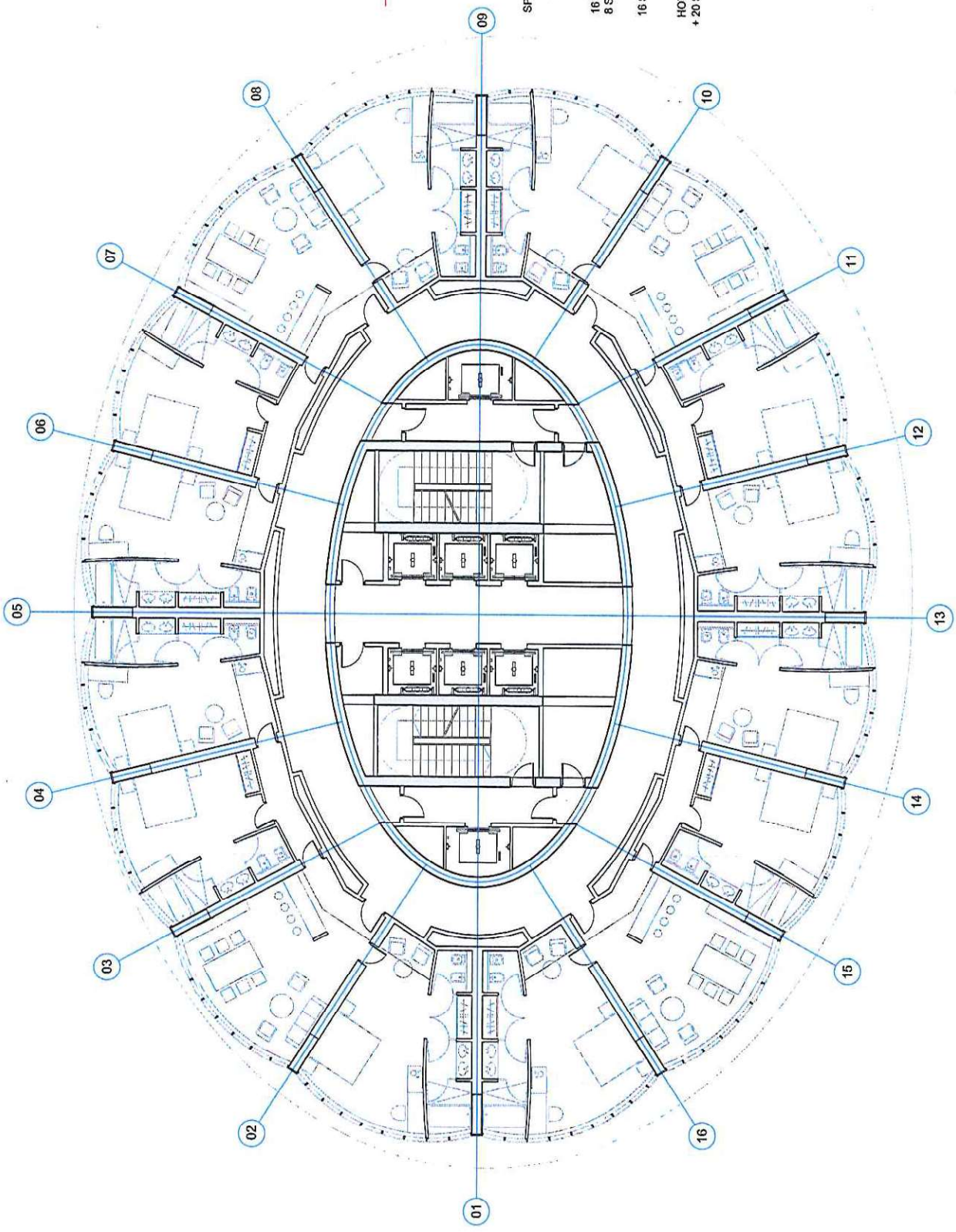

HOTEL USE SCHEME

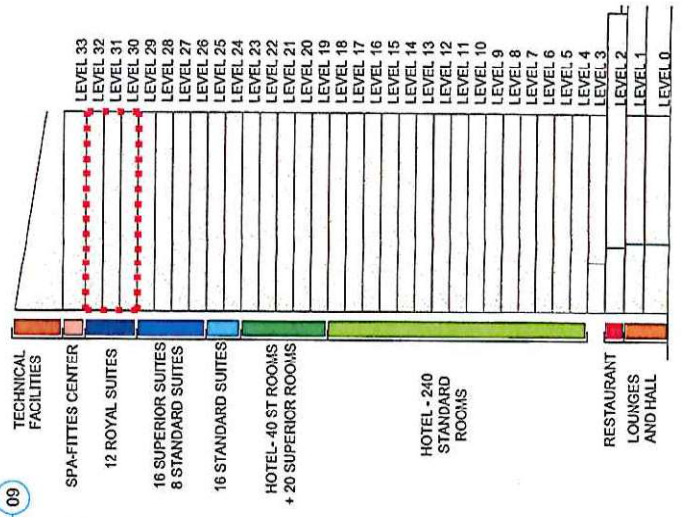

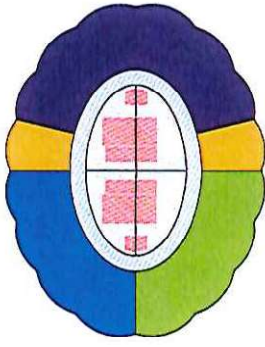

- Uses
- VERTICAL COMMUNICATION
 - HORIZONTAL COMMUNICATION
 - RESTAURANT
 - MEETING ROOMS
 - LOUNGE BAR
 - WELLNESS SPA

1 2 3 4 5
10m SCALE (1/50)



HOTEL USE SCHEME

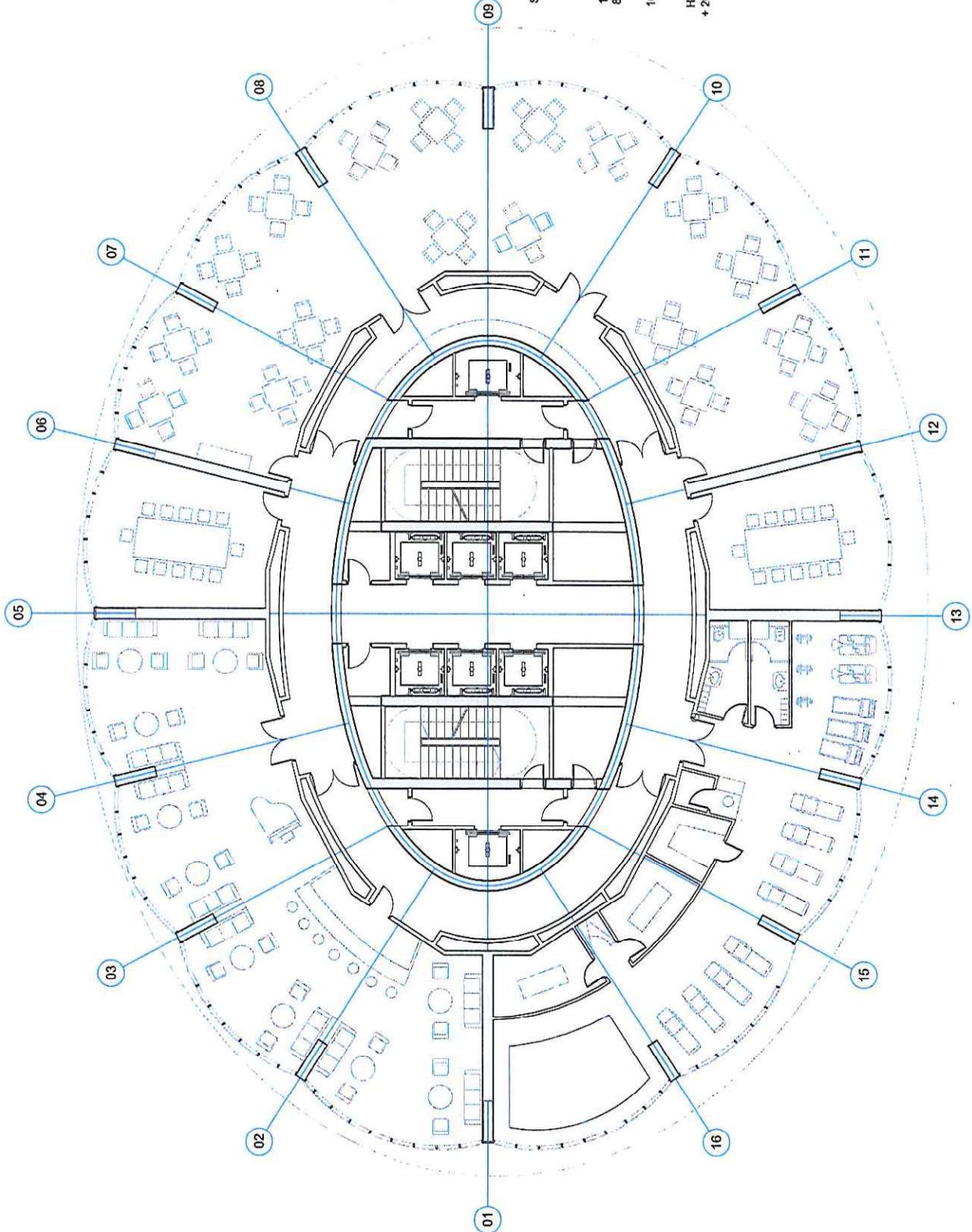
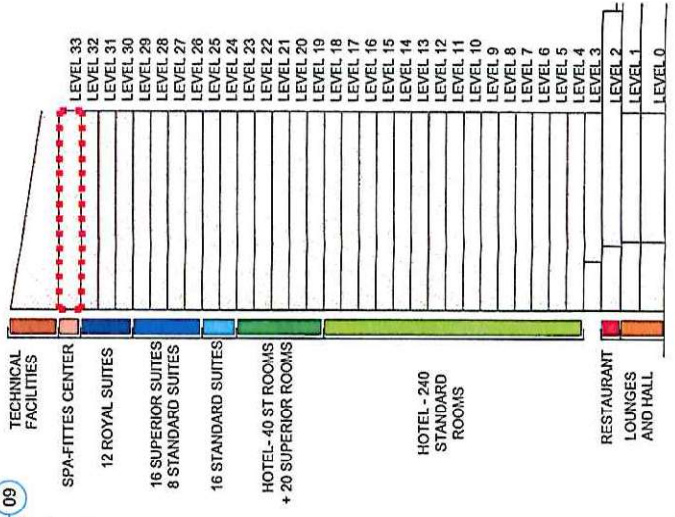

+128.88m
 LEVEL 35 +123.08m
 LEVEL 34 +118.66m
 LEVEL 33 +115.26m
 LEVEL 32 +111.86m
 LEVEL 31 +108.46m
 LEVEL 30 +105.06m
 LEVEL 29 +101.66m
 LEVEL 28 +98.26m
 LEVEL 27 +94.86m
 LEVEL 26 +91.46m
 LEVEL 25 +88.06m
 LEVEL 24 +84.66m
 LEVEL 23 +81.26m
 LEVEL 22 +77.86m
 LEVEL 21 +74.46m
 LEVEL 20 +71.06m
 LEVEL 19 +67.66m
 LEVEL 18 +64.26m
 LEVEL 17 +60.86m
 LEVEL 16 +57.46m
 LEVEL 15 +54.06m
 LEVEL 14 +50.66m
 LEVEL 13 +47.26m
 LEVEL 12 +43.86m
 LEVEL 11 +40.46m
 LEVEL 10 +37.06m
 LEVEL 9 +33.66m
 LEVEL 8 +30.26m
 LEVEL 7 +26.86m
 LEVEL 6 +23.46m
 LEVEL 5 +20.06m
 LEVEL 4 +16.66m
 LEVEL 3 +13.26m
 LEVEL 2 +09.86m
 LEVEL 1 +04.76m
 LEVEL 0 +00.00m

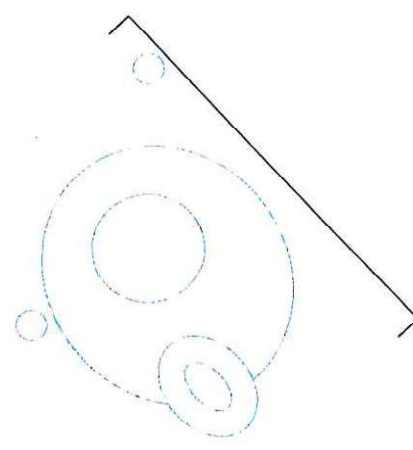
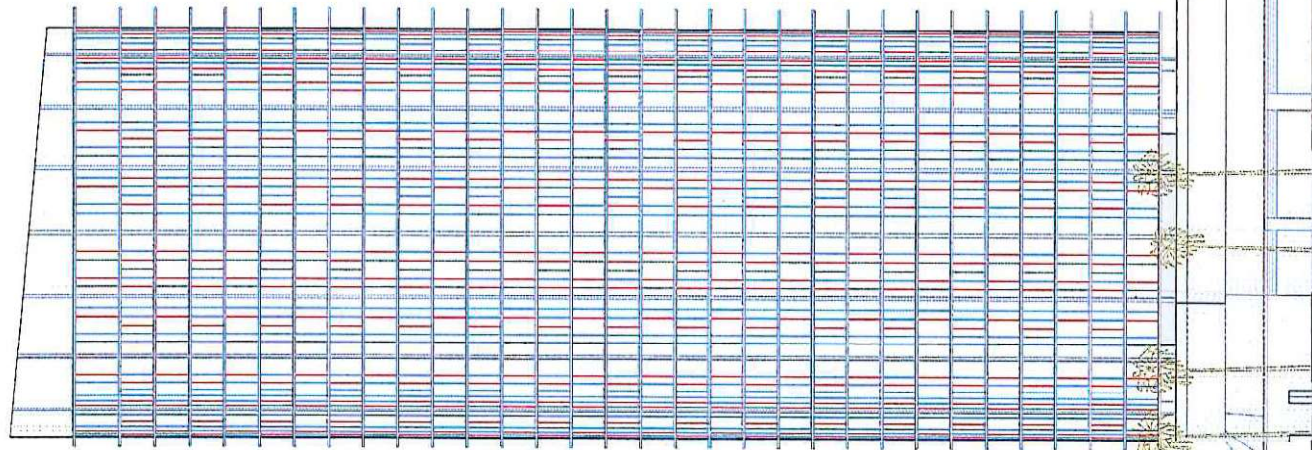

5 10 15 20 25 30m SCALE 1/500

- TECHNICAL FACILITIES
- SPA-FITTERS CENTER
- 11 ROYAL SUITES
- 15 SUPERIOR SUITES & STANDARD SUITES
- 145 STANDARD SUITES
- HOTEL - 43 ST ROOMS + 20 SUPERIOR ROOMS
- HOTEL - 430 STANDARD ROOMS
- RESTAURANT LOUNGES AND HALL

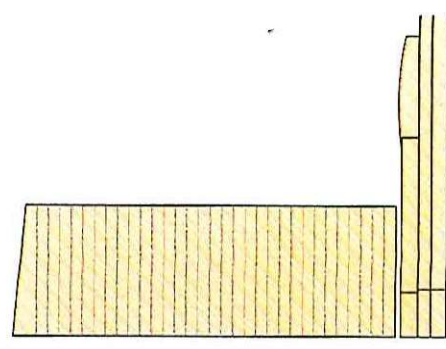

+128.85m
 LEVEL 35
 +123.00m
 LEVEL 34
 +118.66m
 LEVEL 33
 +115.20m
 LEVEL 32
 +111.86m
 LEVEL 31
 +108.46m
 LEVEL 30
 +105.06m
 LEVEL 29
 +101.66m
 LEVEL 28
 +98.26m
 LEVEL 27
 +94.86m
 LEVEL 26
 +91.46m
 LEVEL 25
 +88.06m
 LEVEL 24
 +84.66m
 LEVEL 23
 +81.26m
 LEVEL 22
 +77.86m
 LEVEL 21
 +74.46m
 LEVEL 20
 +71.06m
 LEVEL 19
 +67.66m
 LEVEL 18
 +64.26m
 LEVEL 17
 +60.86m
 LEVEL 16
 +57.46m
 LEVEL 15
 +54.06m
 LEVEL 14
 +50.66m
 LEVEL 13
 +47.26m
 LEVEL 12
 +43.86m
 LEVEL 11
 +40.46m
 LEVEL 10
 +37.06m
 LEVEL 9
 +33.66m
 LEVEL 8
 +30.26m
 LEVEL 7
 +26.86m
 LEVEL 6
 +23.46m
 LEVEL 5
 +20.06m
 LEVEL 4
 +16.66m
 LEVEL 3
 +13.26m
 LEVEL 2
 +9.86m
 LEVEL 1
 +6.46m
 LEVEL 0
 +0.00m

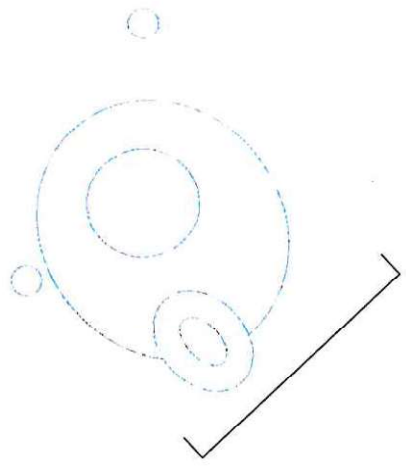
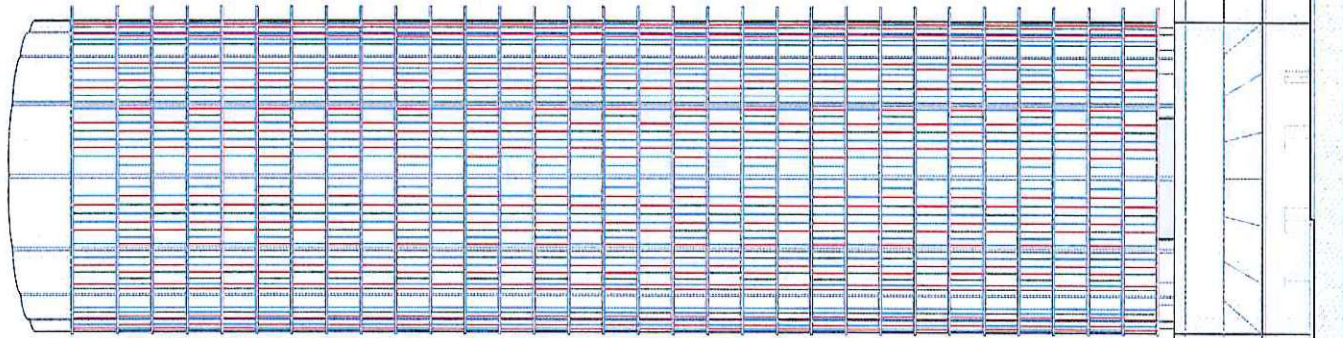

5 10 15 20 25 30m SCALE: 1/500

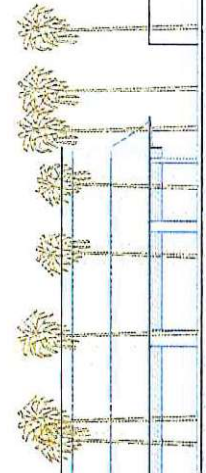
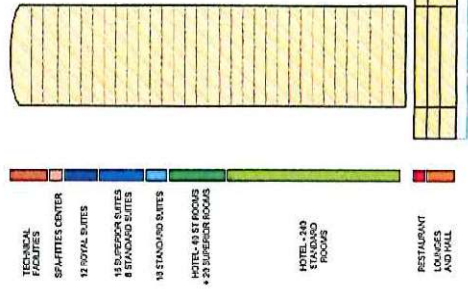

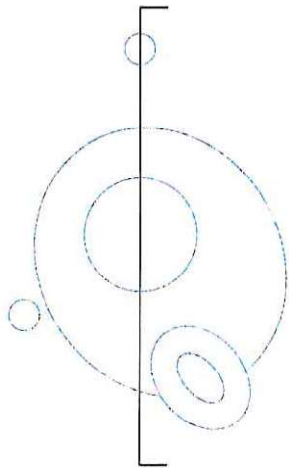
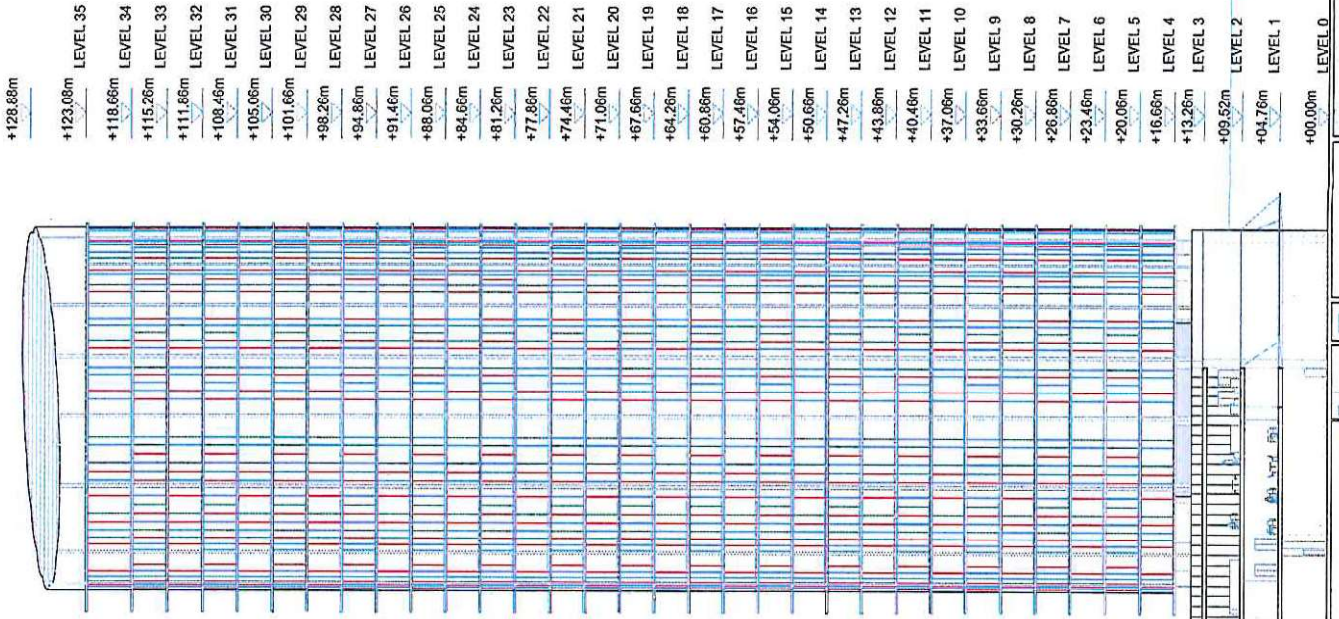

5 10 15 20 25 30m SCALE 1/600

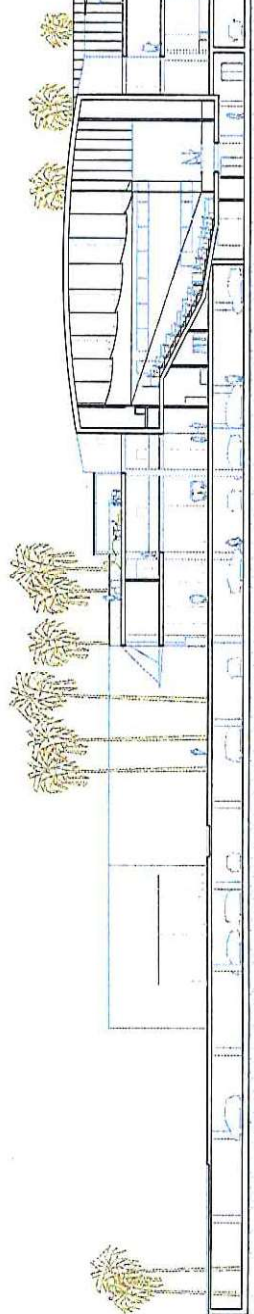
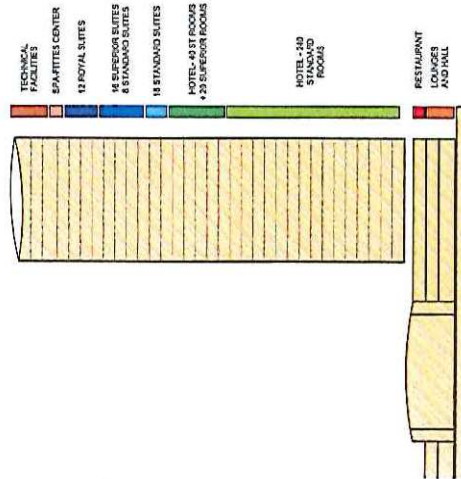

SUMMARY OF THE PROPOSAL, HOTEL-SUITES "MALAGA PORT"

30 LONGITUDINAL SECTION
scale 1/500



ESTUDIO S/GUI
ESTUDIO S/GUI S.L. - ESTUDIO S/GUI S.L. - ESTUDIO S/GUI S.L.

+128.86m
 LEVEL 35
 +123.08m
 LEVEL 34
 +118.66m
 LEVEL 33
 +115.26m
 LEVEL 32
 +111.86m
 LEVEL 31
 +108.46m
 LEVEL 30
 +105.06m
 LEVEL 29
 +101.66m
 +98.26m
 LEVEL 28
 +94.86m
 LEVEL 27
 +91.46m
 LEVEL 26
 +88.06m
 LEVEL 25
 +84.66m
 LEVEL 24
 +81.26m
 LEVEL 23
 +77.86m
 LEVEL 22
 +74.46m
 LEVEL 21
 +71.06m
 LEVEL 20
 +67.66m
 LEVEL 19
 +64.26m
 LEVEL 18
 +60.86m
 LEVEL 17
 +57.46m
 LEVEL 16
 +54.06m
 LEVEL 15
 +50.66m
 LEVEL 14
 +47.26m
 LEVEL 13
 +43.86m
 LEVEL 12
 +40.46m
 LEVEL 11
 +37.06m
 LEVEL 10
 +33.68m
 LEVEL 9
 +30.26m
 LEVEL 8
 +26.86m
 LEVEL 7
 +23.46m
 LEVEL 6
 +20.06m
 LEVEL 5
 +16.66m
 LEVEL 4
 +13.26m
 LEVEL 3
 +09.52m
 LEVEL 2
 +04.76m
 LEVEL 1
 +00.00m
 LEVEL 0

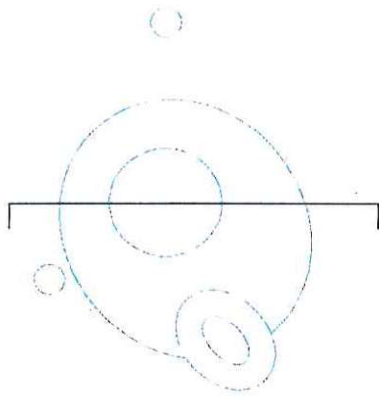
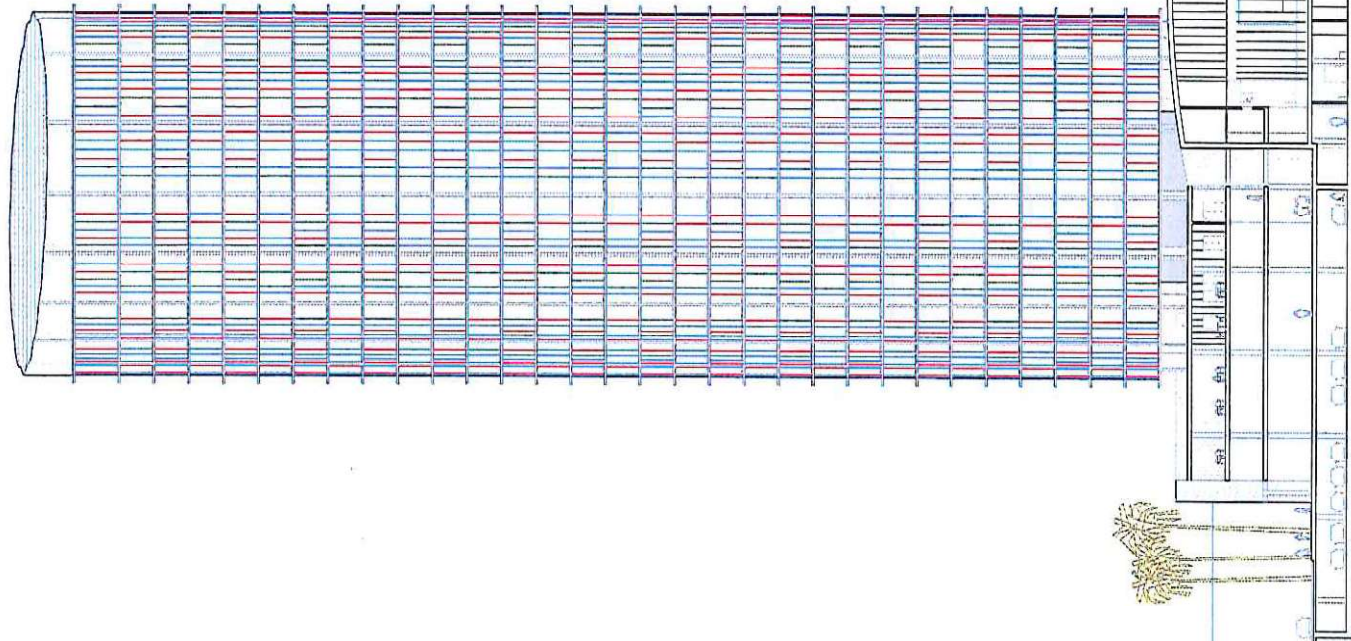

5 10 15 20 25 30m SCALE 1/500

